

GAST/JUN-AIR

GAST MFG. INC./JUN-AIR
A Unit of GSI Corporation
Post Office Box 57
Benton Harbor, Michigan 49022 U.S.A.
Ph: 268/850-6071
Fax: 268/850-8088

PART NUMBER: RTD900

REVISION: C

PRODUCT SPECIFICATIONS

MODEL NO.	MOTOR	RPM		AMPS		HP	KW	NET WT.		CAPACITOR	
		60HZ	50HZ	60HZ	50HZ			lbs.	kg	mfd.	VOLT
87R642-103R-N470X	115-120/230-240 (60/50) 110-120/230-240 (50/60)	1725	1425	5.7/2.8	5.1/2.6	1/2	0.37	19.1	8.6	30	370

SOUND LEVEL LESS THAN 65 db(A)

NORMAL AMBIENT +5 °C - +40 °C

RELATIVE HUMIDITY 20% - 80%

ENVIRONMENT CLEAN DUST FREE

NOTES:

1. TECHNICAL DATA SUBJECT TO CHANGE WITHOUT NOTICE.
2. THIS PUMP MUST BE INSTALLED IN AN ENCLOSURE.
3. ALL DIMENSIONS ARE FOR REFERENCE ONLY.
4. KIT P/N: K965
5. THIS MODEL HAS A BIASED VALVE TO AID RESTART.

PRODUCT PERFORMANCE: 50Hz CURVES BASED ON 230V.
60Hz CURVES BASED ON 115V.

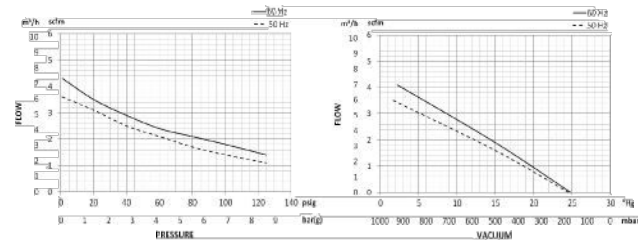

PRODUCT DIMENSIONS:

WIRING DIAGRAM

115V	230V
BRN → CAP	BRN → CAP
YELLOW → LINE	YELLOW → LINE
WHT → LINE	WHT → LINE
BLK → LINE	BLU → LINE
BLU → LINE	BLK → LINE
ORG →	RED →
	ORG-INSULATED

CAPACITOR MOUNTING KIT
TO BE SHIPPED UNATTACHED.



CAPACITOR TO BE SHIPPED UNATTACHED

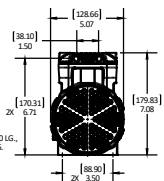
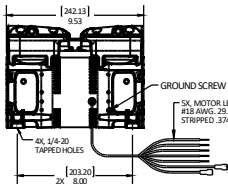

2X MOTOR LEADS
#18 AWG. 28.0 ±1.0 LG.,
.032 x .250 FEMALE TERMINALS,
BRN & YEL LEADS (TO CAPACITOR)